



WORLDWIDE ELECTRIC MOTOR DATA SHEET



ATJ13-36-56JB

| | |
|--------------------|------------------------|
| HP | 1/3 |
| RPM / POLES | 3600 / 2 |
| VOLTAGE / PHASE | 208-230/460 V / 3 |
| FRAME | 56J |
| ENCLOSURE | TEFC |
| FREQUENCY | 60 HZ |
| RATED SPEED | 3450 RPM |
| FULL LOAD AMPS | 1.8-1.6/0.8 A |
| DUTY CYCLE | CONTINUOUS |
| SERVICE FACTOR | 1.15 |
| INSULATION CLASS | F |
| BASE TYPE | C-FACE - REMOVABLE |
| SHAFT | THREADED |
| DE BEARING | 6203 |
| ODE BEARING | 6203 |
| MOUNTING | F1 |
| ROTATION | CW |
| OVERLOAD | --- |
| START CAPACITOR | --- |
| RUN CAPACITOR | --- |
| WIRE TYPE | LOOSE WIRE |
| WIRE HOUSING | JUNCTION BOX |
| CONNECTION DIAGRAM | 208-230/460 V - 9 LEAD |
| APPROX. WEIGHT | 22 LBS. |
| FL EFFICIENCY | 57.0% |



REVISED - 01/01/11



WORLDWIDE ELECTRIC MOTOR DRAWING
ATJ13-36-56JB

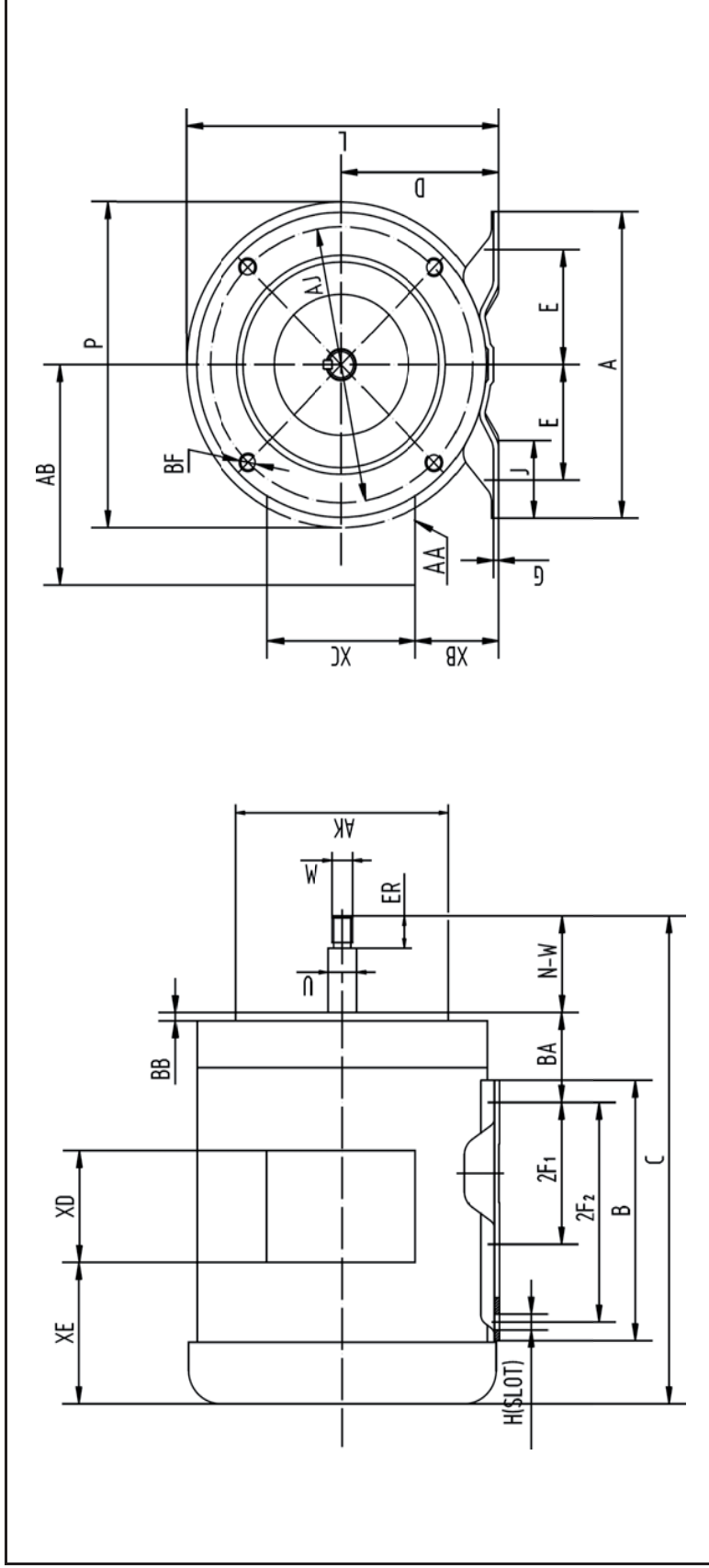

| MOUNTING | | | | |
|----------|-----|-----|------|------|
| E | 2F1 | 2F2 | H | BA |
| 2.44 | 3 | 5 | 0.34 | 2.75 |

| A | B | C | D | G | J | L | P | AA |
|-----|-----|------|-----|------|------|---|-----|-----|
| 6.5 | 6.5 | 12.7 | 3.5 | 0.12 | 1.73 | 7 | 6.9 | 1/2 |

| FLANGE | | | | SHAFT | | | | TERMINAL BOX | | | | |
|--------|-------|-----|------|--------|------|---------|-----|--------------|------|-----|------|------|
| AB | AJ | AK | BB | BF | ER | M | N-W | U | XB | XC | XD | XE |
| 5.35 | 5.875 | 4.5 | 0.16 | 3/8-16 | 0.68 | 7/16-20 | 2.4 | 0.625 | 1.65 | 3.7 | 3.23 | 2.85 |

ALL DIMENSIONS IN INCHES